

HARDWARE

## SECTION F: HARDWARE



**LEAD SHIELD ANCHORS FOR LAG BOLTS**

Catalog Number	Bolt Diameter	Shield Length	Drill Size	Put Up
1815-00200	1/4"	1"	1/2"	50
1815-00300	1/4"	1-1/2"	1/2"	50
1825-00200	3/8"	1-3/4"	5/8"	50
1825-00300	3/8"	2-1/2"	5/8"	50
1835-00200	1/2"	2"	3/4"	25
1835-00300	1/2"	3"	3/4"	25

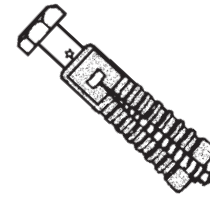

**PLASTIC SCREW ANCHORS**

Catalog Number	Screw Size	Anchor Length	Drill Size	Put Up
0608-06000	6-8	3/4"	3/16"	100
0610-07000	8-10	7/8"	3/16"	100
0612-10000	10-12	1"	1/4"	100

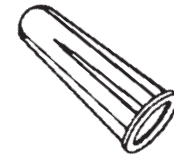

**NYLON ANCHORS**

Catalog Number	Size	Head Style	Put Up
2410-32010	3/16" x 1"	Truss	100
2410-48010	3/16" x 1-1/2"	Truss	100
2415-32010	1/4" x 1"	Truss	100
2415-48010	1/4" x 1-1/2"	Truss	100
2415-64010	1/4" x 2"	Truss	100



**BOLT STOCK**

Catalog Number	Description	Put Up
1/4BOLT	1/4-20 x 36" Steel, Plated	15'
3/8BOLT	3/8-16 x 36" Steel, Plated	15'
1/2BOLT	1/2-13 x 36" Steel, Plated	15'

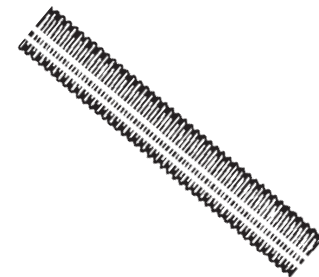

**HEX LAG BOLTS**

Zinc plated.

Catalog Number	Lag Bolt Size	Put Up
L-1/4X1	1/4 x 1"	100
L-1/4X2	1/4 x 2"	100
L-1/4X3	1/4 x 3"	100
L-1/4X4	1/4 x 4"	100
L-1/4X6	1/4 x 6"	100
L-3/8X2	3/8 x 2"	100
L-3/8X3	3/8 x 3"	50
L-3/8X4	3/8 x 4"	50
L-3/8X5	3/8 x 5"	50
L-1/2X2	1/2 x 2"	50
L-1/2X3	1/2 x 3"	50
L-1/2X3.5	1/2 x 3.5"	25
L-1/2X4	1/2 x 4"	25
L-1/2X5	1/2 x 5"	25
L-1/2X6	1/2 x 6"	25

**MACHINE BOLTS**

Zinc plated.

Catalog Number	Lag Bolt Size	Put Up
M-3/8X1	3/8-16 x 1"	100
M-3/8X1.5	3/8-16 x 1.5"	100
M-3/8X2	3/8-16 x 2"	100
M-3/8X3	3/8-16 x 3"	100
M-3/8X4	3/8-16 x 4"	50
M-1/2X1	1/2-13 x 1"	50
M-1/2X1.5	1/2-13 x 1.5"	100
MFT-1/2X2	1/2-13 x 2" Full Thread	50
MFT-1/2X3	1/2-13 x 3" Full Thread	50
MFT-1/2X6	1/2-13 x 6" Full Thread	25



Lag Bolt

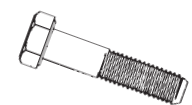

Machine Bolt

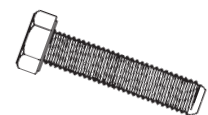

Full Thread Machine Bolt

**ANGLE BRACKETS**

Hot galvanized steel with 5/8" holes. Many other brackets also available.

Catalog Number	Lag Bolt Size	Put Up
STE-301	2" x 2" x 2" 90°	50
STE-304	1-1/2" x 2" x 2" 45°	50
STE-306	1-1/2" x 2" x 5" 90°	50

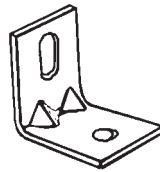

STE-301

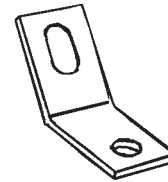

STE-304

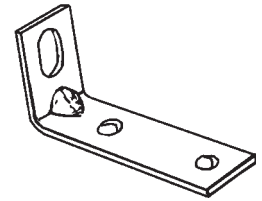

STE-306

**GUY CABLE**

Ductile galvanized seven strand guy cable. For use where exposed to weather.

Catalog Number	Cable Thickness	Put Up
3/16X250	3/16"	250' Roll



**JACK CHAIN**

Zinc plated. Supplied in rolls.

Catalog Number	Size	Load Limit	Put Up
INT-JC-16	#16	10 lbs.	250'
INT-JC-14	#14	16 lbs.	200'
INT-JC-12	#12	29 lbs.	100'

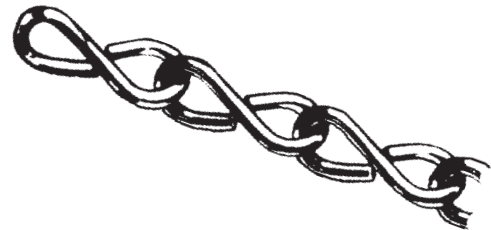

**STEEL PLATED WASHERS**

Catalog Number	Description	Washers per lb.	Min. Order (Pcs.)	Put Up (Pcs.)
<b>Flat Washers</b>				
FW-3/16	3/16"	225	100	1000/18050
FW-1/4	1/4"	156	100	1000/7450
FW-5/16	5/16"	100	100	500/4350
FW-3/8	3/8"	68	100	500/3350
FW-1/2	1/2"	26	50	50/1300
FW-5/8	5/8"	13	50	50/650
FW-3/4	3/4"	10	50	50/550
<b>Lock Washers</b>				
SLW-1/4	1/4"	-	100	100
SLW-3/8	3/8"	-	100	100
SLW-1/2	1/2"	-	100	100
SLW-5/8	5/8"	-	100	100
SLW-3/4	3/4"	-	100	100
<b>Rivet Backup Washers</b>				
SBUP-1/8	1/8"	-	500	500
SBUP-3/16	3/16"	-	500	500

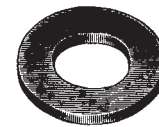

Flat Washer



Lock Washer



Backup Washer

Hardware

## HIGH SPEED TWIST DRILL BITS

PRECISION



Catalog Number	Reference Number	Lag Bolt Size	Put Up
R41C*	135	Short, Numerical, Coated, 135° Point	12 Drills
R40C**	135	Short, Fractional, Coated, 135° Point	12 Drills 1/8 to 19/64 6 Drills 5/16 to 1/2
R18*	115	Jobber, Numerical, Coated, 118° Point	12 Drills
R10**	115	Jobber, Fractional, Coated, 118° Point	12 Drills 1/8 to 19/64 6 Drills 5/16 to 1/2
R7***	120	Short, 1/4" Shank, Fractional	6 Drills
140-30	-	#30 Double ended	12 Drills

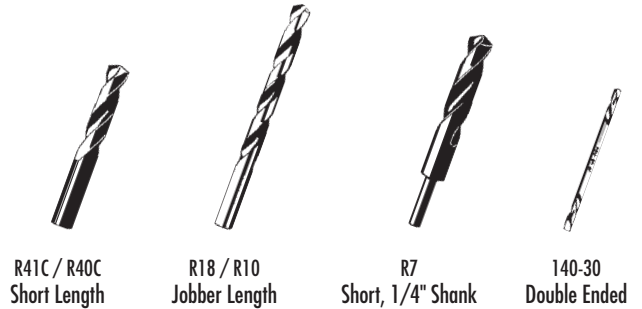

### Ordering Information

Items with "\*" suffix indicates sizes desired:  
Substitute "\*\*" with 1 to 60.  
Substitute "\*\*\*" with 1/8 to 1/2 by 64th.  
Substitute "\*\*\*\*" with 5/16, 3/8 or 1/2.

## MASONRY DRILL BITS

Catalog Number	Reference Number	Hole Dia.	Depth	Shank	Put Up
1410-00	215-3/16	3/16"	2-1/2"	Round	10
1415-00	215-1/4	1/4"	3-1/2"	Round	10
1425-00	215-3/8	3/8"	4-1/2"	Round	10
1435-00	215-1/2	1/2"	4-1/2"	Round	10
1445-00	215-5/8	5/8"	4-1/2"	1/2" Round	10
1455-00	215-3/4	3/4"	4-1/2"	1/2" Round	10

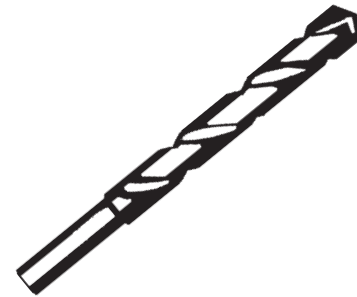

## HEAT GUNS

Ideal wherever a fast, portable, flameless heat is needed.

Catalog Number	Description
MAS-HG-751B	750°-1000°, 120V Heat Gun
MAS-043K	Replacement Element for HG-751B



MASTER  
appliance corporation

## HEATING TAPES

General purpose heating tapes used for bending sheet plastic. Supplied with a rugged 0-100% controller.

Catalog Number	Description
BRI-6	6'x1", 432 Watt w/Controller
BRI-8	8'x1", 576 Watt w/Controller



BriskHeat

Hardware



**HOLE SAWS**

Bi-metal hole saws are recommended for cutting woods, plastics, machinable metals, nail embedded wood, pipe, etc. Carbide hole saws are recommended for cutting abrasive materials such as fiberglass, particle board, formica and cast iron.

1-1/2" cutting depth. 1 per box.

Catalog Number Bi-Metal	Catalog Number Carbide Tipped	Dia. (Inches)	Dia. (mm)
BLU-509	-	9/16	14
BLU-510	-	5/8	16
BLU-512	-	3/4	19
BLU-514	BLU-C14	7/8	22
BLU-516	BLU-C16	1	25
BLU-518	-	1-1/8	29
BLU-520	BLU-C20	1-1/4	32
BLU-521	-	1-5/16	33
BLU-522	BLU-C22	1-3/8	35
BLU-524	BLU-C24	1-1/2	38
BLU-532	-	2	51

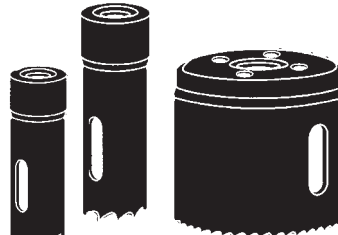

Bi-Metal

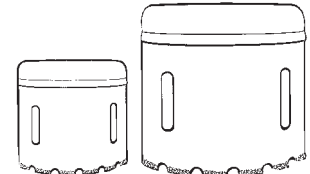

Carbide Tipped

**HOLE SAW MANDRELS**

1 per box.

Catalog Number	Fits Hole Saws	Shank Size	Chuck Size
BLU-5514	9/16" to 1-1/2"	1/4 Round	1/4
BLU-5518	9/16" to 1-1/2"	7/16 Hex	1/2
BLU-5520	1-1/4" to 2-3/8"	7/16 Hex	1/2
BLU-5545	1-1/4" to 6"	7/16 Hex	1/2
BLU-8535	Replacement Pilot Drill, 4" x 1/4", 3 Set Screw Notches		

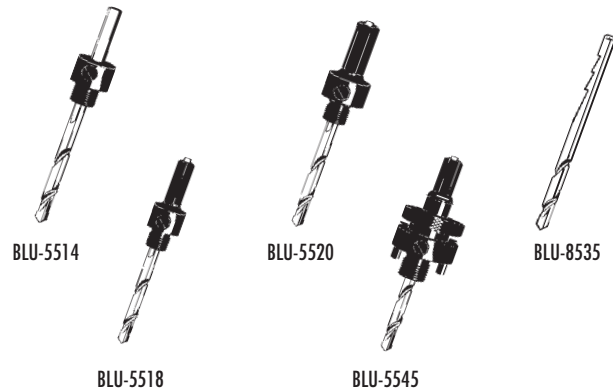

**ALUMINUM LADDERS**

Alaco aluminum ladders are heavy duty industrial quality ladders. All aluminum construction guards against corrosion. 5200 series ladders are standard extension type. 5210 series ladders have a combination bracket that allows for use as an extension ladder or as an "A" frame ladder. Both are equipped with a stand off and pole rest. Step ladders are two-sided. Other models and sizes also available.



Catalog Number	Extended Height	Un-Extended Height	Weight (Lbs.)
5210-16-PRS	13' - 2"	8' - 3"	26
5210-24-PRS	21' - 2"	12' - 3"	36
5210-28-PRS	25' - 2"	14' - 3"	42
5210-32-PRS	29' - 2"	16' - 3"	47
5200-16-PRS	13' - 2"	8' - 3"	26
5200-24-PRS	21' - 2"	12' - 3"	36
5200-32-PRS	29' - 2"	16' - 3"	47
1020-10	Two-Sided Step Ladder, 112"		41
ALA-KH60	Replacement Shoe for 5210 Series & 5200 Series		

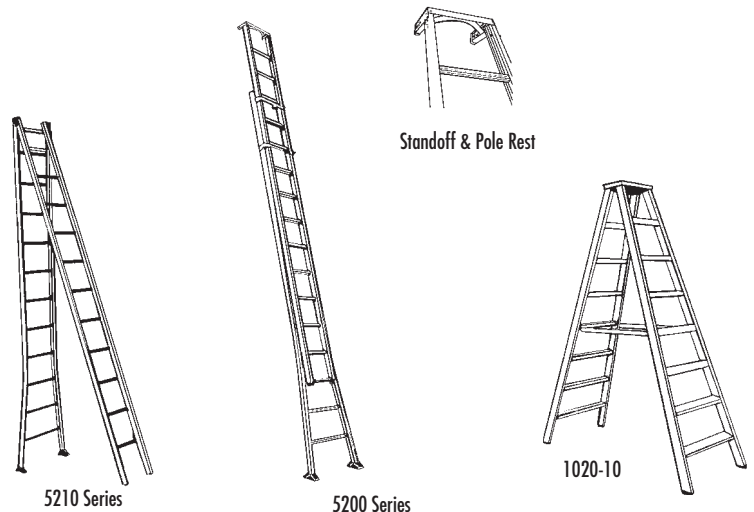

Hardware

**HEX NUTS**

Zinc plated.

Catalog Number	Description	Put Up	Min. Order
H-8-32	8-32 - Plated Steel	100/1000	100
H-10-24	10-24 - Plated Steel	100/1000	100
H-10-32	10-32 - Plated Steel	100/1000	100
H-1/4	1/4-20 - Plated Steel	100/1000	100
H-3/8	3/8-16 - Plated Steel	100/1000	100
H-1/2	1/2-13 - Plated Steel	50/500	-
H-5/8	5/8-11 - Plated Steel	50/500	-
H-3/4	3/4-10 - Plated Steel	50/500	-

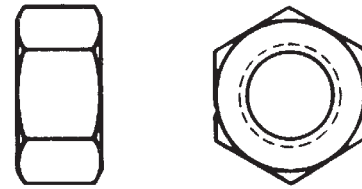

**BLIND RIVETS • OPEN END DOMED**

Catalog numbers ending with LF are large flange head rivets. Steel rivets are plated. Clearance hole drill bit sizes are #30 for 1/8" rivets and #11 for 3/16" rivets. Minimum order is 1000. Other sizes and types also available.



Catalog Number	Reference Number	Material	Rivet Dia.	Max. Grip	Case Qty.
SD42BS	SB4-2	Steel	1/8	1/8	10,000
SD43BS	SB4-3	Steel	1/8	3/16	10,000
SD44BS	SB4-4	Steel	1/8	1/4	10,000
SD46BS	SB4-6	Steel	1/8	3/8	10,000
SD48BS	SB4-8	Steel	1/8	1/2	8,000
SD66BS	SB6-6	Steel	3/16	3/8	4,500
SD68BS	SB6-8	Steel	3/16	1/2	4,000
SD42BSLF	SBL4-2	Steel	1/8	1/8	10,000
SD44BSLF	SBL4-4	Steel	1/8	1/4	8,000
AD42ABS	AB4-2A	Aluminum	1/8	1/8	10,000
AD44ABS	AB4-4A	Aluminum	1/8	1/4	10,000
AD42BSLF	ABL4-2A	Aluminum	1/8	1/8	10,000

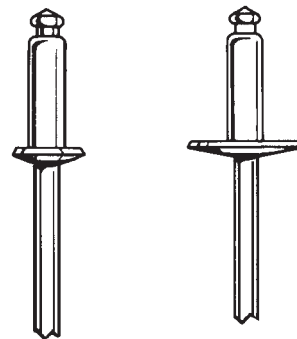

Large flange head

**RIVET TOOLS**

PRP26A is a heavy duty rivet tool. PL-30 is a newly designed rivet tool with a protruding nose. Other features include: hide away storage of extra nosepieces and wrench in the bottom of ergonomically designed contoured grips. A compact easy flip-lock and patented CAM link system which makes it easier to use. ROP-8000 has a two position nosepiece which can be set in-line or at 90°. PRG510A is a production quality pneumatic rivet gun. PRG511A comes equipped with an extended nosepiece. Guns are not supplied with an air line assembly. Order PRT5200-220 air line assembly if needed.



Catalog Number	Description	Max. Capacity	Mfg.
EMH-PRP26A	Hand Riveter	1/8" Steel	POP
EMH-PL-30	PowerLink 30 Hand Riveter	3/16" Steel	POP
ROP-8000	Dual Position Hand Riveter	3/16" Steel	Roper
EMH-PRG510A	Air Riveter	3/16" Steel	POP
EMH-PRG511A	Air Riveter w/Ext. Nosepiece	3/16" Steel	POP
PRT5200-220	Complete Air Line Assembly	-	POP
PRG511-003	PRG-510A to PRG-511 Conversion Kit	-	POP

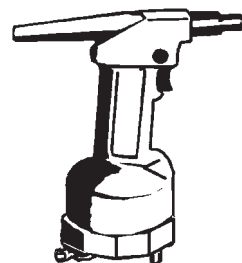

EMH-PRG510A  
EMH-PRG511A

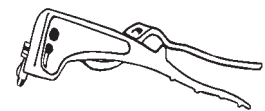

EMH-PRP26A

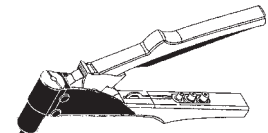

EMH-PL-30

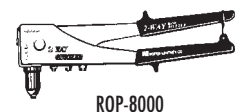
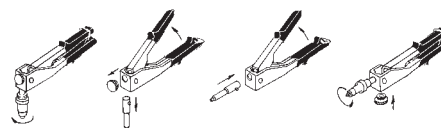

ROP-8000

Hardware

**REPLACEMENT PARTS FOR  
EMH-PRP402HC RIVET TOOL**

Parts normally stocked.

Catalog Number	Description
PRG402-8A	Jaws
PRG402-100	Fulcrum Pin Retainer
PRG402-101	Jaw Pusher Spring
PRG402-6	Riveter Support
PRG402-11	Nose Housing
PRN414	Nosepiece for 1/8"
PRN514	Nosepiece for 5/32"
PRN614	Nosepiece for 3/16"
PRP40	Fulcrum Pin

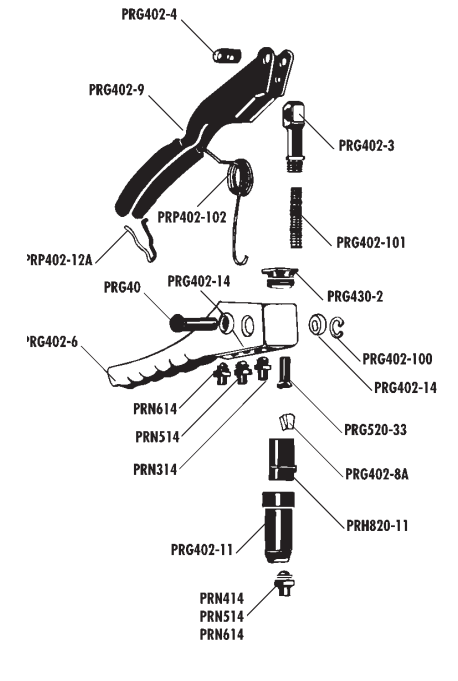

**REPLACEMENT PARTS FOR  
EMH-PRP26A RIVET TOOL**

Parts normally stocked.

Catalog Number	Description
PRG402-100	Fulcrum Pin Retainer
PRP11	Jaws for 1/8" Rivets
PRP30	Jaw Pusher
PRP32	Nosepiece for 1/8"
PRP40	Fulcrum Pin
PRP100	Collet Spring Screw
PRP101	Jaw Pusher Washer

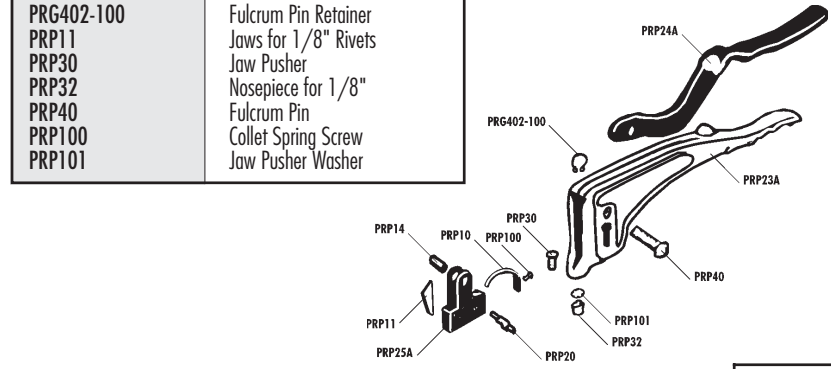

Emhart  
POP

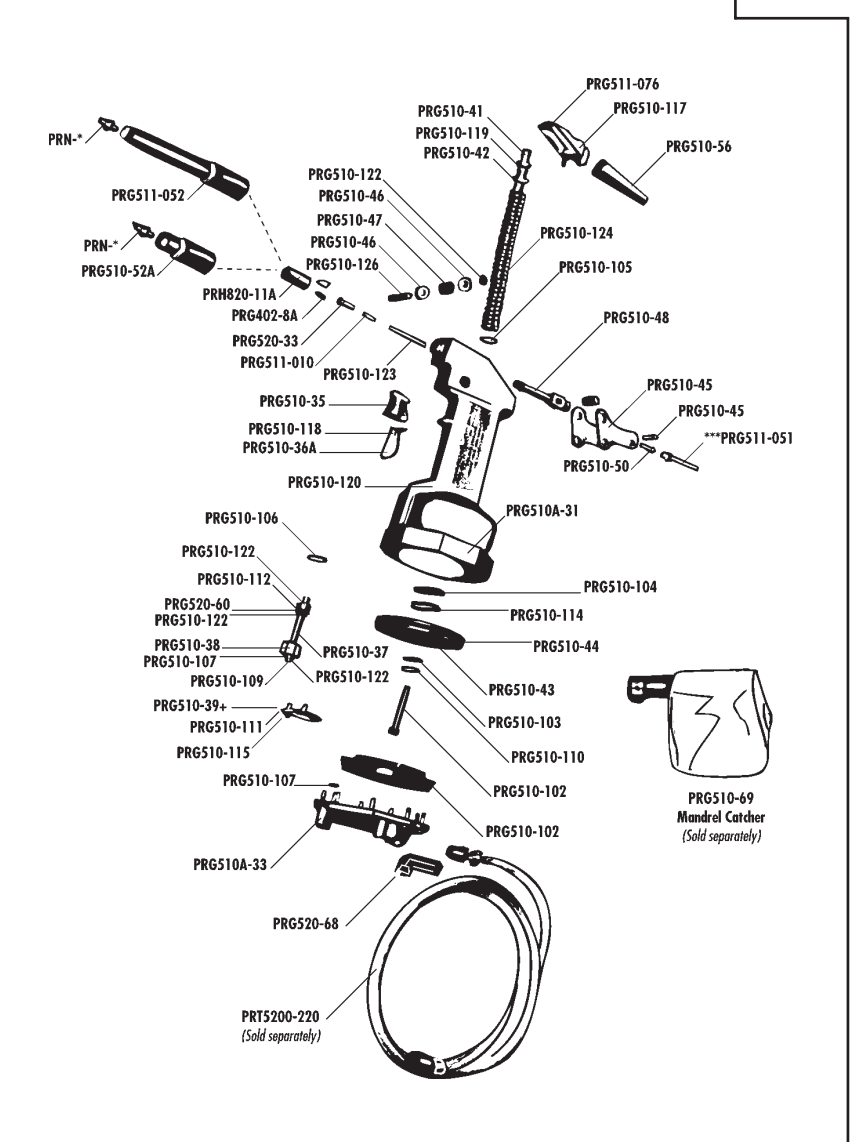

**REPLACEMENT PARTS FOR  
EMH-PRG510A/511A AIR RIVET TOOLS**

Parts normally stocked.

Catalog Number	Description
PRG402-8A	Jaws
PRG510-34	Nose Housing Insert
PRG510-46	Bell Crank Bushing, Outer
PRG510-47	Bell Crank Bushing, Center
PRG510-50	Mandrel Tube
PRG510-52A	Nose Housing
PRG510-107	Valve Ring Seal (1)
PRG510-117	Housing Cap Screw
PRG510-122	Valve Ring Seal Retainer
PRG510-123	Jaws Pusher Spring
PRG510-126	Bell Crank Fulcrum
PRG511-051	Mandrel Guide
PRG520-68	Elbow Fitting
PRH820-11A	Jaw Guide
PRT5200-220	Air Line Assembly

Hardware

## SHEET METAL SCREWS

Plated steel. Minimum order is 100.

Catalog Number	Size	Put Up
Type A, Pan Head, Slotted		
A7X3/8PS	7 x 3/8"	100, 1M, 5M
A7X1/2PS	7 x 1/2"	100, 1M, 5M
A7X3/4PS	7 x 3/4"	100, 1M, 5M
A7X1PS	7 x 1"	100
Type A, Pan Head, Phillips		
A7X1/2PP	7 x 1/2"	100, 1M, 5M
A7X3/8PP	7 x 3/8"	100, 1M, 5M
Type A, Hex Head, Slotted		
A8X1/2HS	8 x 1/2"	100, 1M, 5M
A8X3/4HS	8 x 3/4"	100, 1M
A8X1HS	8 x 1"	100, 1M
A10X1/2HS	10 x 1/2"	100, 1M, 5M
A10X3/4HS	10 x 3/4"	100, 1M, 5M
A10X1.25HS	10 x 1-1/4"	100, 1M
A10X2HS	10 x 2"	100, 1M
Type F, Pan Head, Slotted		
F8-32X1/2PS	8-32 x 1/2"	100
Drillquick, Hex-Washer Head		
1908-16024	8-18 x 1/2"	100/1M
1908-24024	8-18 x 3/4"	100/1M
1909-16034	10-16 x 1/2"	100/1M
1909-24034	10-16 x 3/4"	100/1M
1909-32034	10-16 x 1"	100/1M
1909-40034	10-16 x 1-1/4"	100/1M
1909-48034	10-16 x 1-1/2"	100/1M



Pan Head Slotted  
Type A



Pan Head Phillips  
Type A



Hex Head Slotted  
Type A



Pan Head Slotted  
Type F



Drillquick  
Hex Washer Head

## MACHINE SCREWS

Plated steel. Minimum order is 100.

Catalog number suffix: R = round head and T = truss head.

Catalog Number	Length Inches	Put Up
8-32X.5R	1/2"	100, 1M
8-32X.75R	3/4"	100, 1M
8-32X1R	1"	100, 1M
10-24X3R	3	100, 1M
10-24X4R	4	100, 1M
1/4X.5R	1/2	100, 1M
1/4X.75R	3/4	100, 1M
1/4X.75T	3/4	100, 1M
1/4X1R	1	100, 1M
1/4X1T	1	100, 1M
1/4X1.25R	1-1/4	100, 1M
1/4X1.5R	1-1/2	100, 1M
1/4X1.75R	1-3/4	100, 1M
1/4X2R	2	100, 1M
1/4X3R	3	100, 1M
1/4X4R	4	100, 1M



Sheet Metal Screw  
Round Head

## TOGGLE BOLTS

Plated steel. All toggle bolts come complete with snap-in heads. Order appropriate round head machine screws for screws only.

Catalog Number	Size	Screw Size	Put Up
3005-40100	1/8 x 4	8-32 x 4	50
3010-30000	3/16 x 3	10-24 x 3	50
3010-40000	3/16 x 4	10-24 x 4	50
3015-30000	1/4 x 3	1/4-20 x 3	50
3015-40000	1/4 x 4	1/4-20 x 4	50
3015-50000	1/4 x 5	1/4-20 x 5	50
3015-60000	1/4 x 6	1/4-20 x 6	50
3025-30000	3/8 x 3	3/8-16 x 3	25
3025-40000	3/8 x 4	3/8-16 x 4	25
3025-50000	3/8 x 5	3/8-16 x 5	25
3025-60000	3/8 x 6	3/8-16 x 6	25
3010-00600	3/16 Snap-In Head Only		50
3015-00600	1/4 Snap-In Head Only		50
3025-00600	3/8 Snap-In Head Only		50

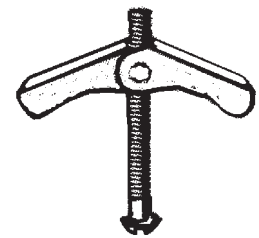

Toggle Screw  
w/Snap-In Head



**FASTENER INFORMATION**

Where substitution is necessary, use next larger size drill bit.  
 All tap drill sizes represent 75% full thread except asterisked sizes which represent 60% full thread.



Type A



Type AB

Drill this size hole		To tap for this size bolt or screw	For this size wood screw pilot in hard wood
Drill size	Dec. equiv.		
60	.0400		
59	.0410		
58	.0420		
57	.0430		
56	.0465	0 x 80	
3/64	.0469		
55	.0520		
54	.0550	1 x 56	No. 3
53	.0595	1 x 64 x 72	
1/16	.0625		
52	.0635		No. 4
51	.0670		
50	.0700	2 x 56-64	
49	.0730		No. 5
48	.0760		
5/64	.0781		
47	.0785	3 x 48	No. 6
46	.0810		
45	.0820	3 x 56	
44	.0860	4 x 36	No. 7
43	.0890	4 x 40	
42	.0935	4 x 48	
3/32	.0937		
41	.0960		
40	.0980	5 x 36	No. 8
39	.0995		
38	.1015	5 x 40	
37	.1040	5 x 44	No. 9
36	.1069		
7/64	.1094		
35	.1100	6 x 32	
34	.1110	6 x 36	
33	.1130	6 x 40	No. 10
32	.1160		
31	.1200	6 x 48	No. 11
1/8	.1250	7 x 36	
30	.1285	8 x 30	No. 12
29	.1360	8 x 32-36	
28	.1405	8 x 40	
9/64	.1406		
27	.1440	9 x 30	
26	.1470	3/16 x 24	
25	.1495	10 x 24	No. 14
24	.1520		
23	.1540	10 x 28	
5/32	.1562		
22	.1570	10 x 30	
21	.1590	10 x 32	
20	.1610	3/16 x 32	
19	.1660		
18	.1695		No. 16
11/64	.1719		
17	.1730		
16	.1770	12 x 24	
15	.1800		
14	.1820	12 x 28	
13	.1850	12 x 32	No. 18
3/16	.1875		

Drill this size hole		To tap for this size bolt or screw	For this size wood screw pilot in hard wood
Drill size	Dec. equiv.		
12	.1890		
11	.1910		
10	.1935	14 x 20	
9	.1960		
8	.1990		
7	.2010	1/4 x 20	
13/64	.2031		
6	.2040		
5	.2055		
4	.2090	1/4 x 24	No. 20
3	.2130	1/4 x 28	
7/32	.2187	1/4 x 32	
2	.2210		
1	.2280		No. 24
A	.2340		
15/64	.2344		
B	.2380		
c	.2420		
D	.2460		
1/4	.2500		
E	.2500		
F	.2570	5/16 x 18	
G	.2610		
17/64	.2656	5/16 x 18*	
H	.2660		
I	.2720	5/16 x 24	
J	.2770		
K	.2810		
9/32	.2812	5/16 x 24-32*	
L	.2900		
M	.2950		
19/64	.2969		
N	.3020		
5/16	.3125	3/8 x 16-1/8	
O	.3160		
P	.3230		
21/64	.3281	3/8 x 20-24	
Q	.3332		
R	.3390		
11/32	.3437		
S	.3480		
T	.3580		
23/64	.3594		
U	.3680		
3/8	.3750	7/16 x 14	
V	.3770		
W	.3860		
25/64	.3906	7/16 x 20	
X	.3970		
Y	.4040		
13/32	.4062		
Z	.4130		
27/64	.4219	1/2 x 12-13	
7/16	.4375	1/4" Pipe	
29/64	.4531	1/2 x 20-24	
15/32	.4687	1/2 x 27	
31/64	.4844	9/16 x 12	
1/2	.5000		

Screw size	Metal thickness		Type A-AB sharp point Use drill
	Gage	Inches	
No. 4 (.112")	28	.016	No. 44
	26	.019	No. 44
	24	.025	No. 42
	22	.031	No. 42
	20	.038	No. 40
No. 6 (.138")	28	.016	No. 39
	26	.019	No. 39
	24	.025	No. 39
	22	.031	No. 38
	20	.038	No. 36
No. 7 (.155")	28	.016	No. 37
	26	.019	No. 37
	24	.025	No. 35
	22	.031	No. 33
	20	.038	No. 32
No. 8 (.165")	28	.016	No. 33
	26	.019	No. 33
	24	.025	No. 32
	22	.031	No. 31
	20	.038	No. 30
No. 10 (.191")	26	.019	No. 30
	24	.025	No. 30
	22	.031	No. 30
	20	.038	No. 29
	18	.050	No. 25
No. 12 (.218")	24	.025	No. 26
	22	.031	No. 25
	20	.038	No. 24
	18	.050	No. 22
No. 14 (.251")	24	.025	No. 15
	22	.031	No. 12
	20	.038	No. 11
	18	.050	No. 9

Type B



Screw size	Metal thickness		Type A-AB sharp point Use drill
	Gage	Inches	
No. 4 (.112")	28	.016	No. 44
	26	.019	No. 44
	24	.025	No. 43
	22	.031	No. 42
	20	.038	No. 42
No. 6 (.137")	28	.016	No. 37
	26	.019	No. 37
	24	.025	No. 36
	22	.031	No. 36
	20	.038	No. 35
No. 7 (.151")	26	.019	No. 32
	24	.025	No. 32
	22	.031	No. 32
	20	.038	No. 32
	18	.050	No. 31
No. 8 (.163")	26	.019	No. 32
	24	.025	No. 32
	22	.031	No. 32
	20	.038	No. 32
	18	.050	No. 30
No. 10 (.186")	26	.019	No. 27
	24	.025	No. 27
	22	.031	No. 27
	20	.038	No. 27
	18	.050	No. 27
No. 12 (.212")	24	.025	No. 19
	22	.031	No. 19
	20	.038	No. 19
	18	.050	No. 18
No. 14 (.243")	22	.031	No. 13
	20	.038	No. 13
	18	.050	No. 11
	16	.063	No. 8

Hardware

## SCREWDRIVING ACCESSORIES



Other screwdriving accessories also available.

Catalog Number	Description
BLA-DW2221	1/4" Magnetic Socket and 2-9/16" Shank
BLA-DW2222	5/16" Magnetic Socket and 2-9/16" Shank
BLA-DW2115	#2 Phillips Screwdriver Bit
BLA-DW2023	#3 Phillips Screwdriver Bit



Magnetic Socket



Phillips Screwdriver Bit

## HAND TOOL ROUTER BITS & ACCESSORIES



Many other router bits and accessories also available.

Catalog Number	Description	Dimension			Shank Dia.
		A	B	C	
BLA-DW6106	Carbide Tipped, 2 Flute Router Bit	1/8"	5/16"	1"	1/4"
BLA-DW6110	Carbide Tipped, 2 Flute Router Bit	1/4"	1"	1-1/8"	1/4"
BLA-DW6120	Carbide Tipped, 2 Flute Router Bit	1/2"	1"	1-1/16"	1/4"
MAK-7331288A	Carbide Tipped Router Bit, 3/8" Ball Brng.	3/8"	1"	1-1/16"	1/4"
MAK-7331322B	3/8" Replacement Ball Bearing Only	-	-	-	-
SR2ASS	1/2" Replacement Ball Bearing Only	-	-	-	-
CHI-7759	1/8" Spiral Pointed Plastic Cutter	1/8"			1/8"



2 Flute Router Bit

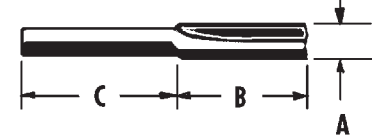

MAK-7331288A



CHI-7759

## ROUTER BITS FOR ROUTING TABLES AND SIGNMAKING EQUIPMENT

Please see Graphics section.

## SOLDER & ACCESSORIES

Catalog Number	Description	Pwt Up
INT-1001	50/50 Bar Solder, 1/2" x 3/4" x 13"	1 lb.
ACID-1	#1 Acid Swab	1



INT-1001



Acid-1



**SHEET METAL HAND TOOLS**



Catalog Number	Description
ROP-141	Notcher, 32°, 20 Gauge Capacity
ROP-541A	Notcher, 90°, 20 Gauge Capacity
ROP-542-45	Notcher, 45°, 20 Gauge Capacity
WIS-M-1R	Aviation Snip, Cuts Left w/Red Grips
WIS-M-2R	Aviation Snip, Cuts Right w/Green Grips
WIS-M-3R	Aviation Snip, Cuts Straight w/Yellow Grips
WIS-W-5	Pattern Snip, 16", 2-1/2" Cut, 16ga. Capacity
PRO-939	Scratch Awl
WIS-P406	Replacement Spring for M-1R
WIS-P407	Replacement Spring for M-2R
ROP-541BLADE	Replacement 90° Blade Set for 541A
ROP-542BLADE	Replacement 45° Blade Set for 542-45



ROP-141



ROP-541A/ROP-542-45



Aviation Snips



WIS-W-5



PRO-939

**ROPER #5JR HAND PUNCH**

Kit comes complete with 3/32, 1/8, 5/32, 3/16, 7/32, 1/4 and 9/32" punches and dies packaged in a handy plastic case. Throat depth is 1-3/4". Throat height is 7/16". Punch capacity is 9/32" 16ga. mild steel.

Catalog Number	Description
ROP-5JR-K	Hand Punch Kit
ROP-5BASE	Bench Mounting Base
ROP-5P-*	Male Round Punch Tooling
ROP-5D-*	Female Round Die Tooling

Punch



Die



ROP-5BASE

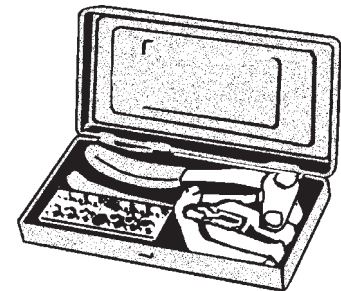

ROP-5JR-K

**Ordering Information**

Items with "\*" suffix indicates size for tooling. Substitute with 1/8, 5/32, 3/16, 1/4 or 9/32.

Hardware

**JORGENSEN "PONY" CLAMP**

Vinyl covered jaws and handles.

Catalog Number	Description
JOR-3202HT	Spring Clamp, 2"x6"

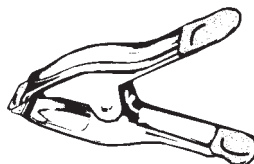

## A&N PUNCH TOOLING

Round punches and dies are interchangeable on AN-B1 or AN-B2 bases. A few hammer blows will make a clean hole in 18 gauge or lighter metal. Blanks fall into a recess in the base. HM tooling produces a "D" shaped panel opening which fits snap-in lampholders. S2-C tooling produces an opening for the EAG-4734-2BU socket. S2-C-L layout tool marks the precise location for the pilot holes when using the S2-C pattern. 211 tooling produces an opening for the CHA-22258.9 socket. 209 tooling produces an opening for the EAG-974-2BU socket.

*A & N  
Tool & Die, Inc.*

Catalog Number	Description
AN-P-5/8	5/8" Round Punch
AN-D-5/8	5/8" Round Die
AN-P-9/16	9/16" Round Punch
AN-D-9/16	9/16" Round Die
AN-P-3/4	3/4" Round Punch
AN-D-3/4	3/4" Round Die
AN-P-7/8	7/8" Round Punch
AN-D-7/8	7/8" Round Die
AN-P-1	1" Round Punch
AN-D-1	1" Round Die
AN-P-1-1/8	1-1/8" Round Punch
AN-D-1-1/8	1-1/8" Round Die
AN-P-1-1/4	1-1/4" Round Punch
AN-D-1-1/4	1-1/4" Round Die
AN-P-1-5/16	1-5/16" Round Punch
AN-D-1-5/16	1-5/16" Round Die
AN-P-1-3/8	1-3/8" Round Punch
AN-D-1-3/8	1-3/8" Round Die
AN-P-1-7/16	1-7/16" Round Punch
AN-D-1-7/16	1-7/16" Round Die
AN-P-1-1/2	1-1/2" Round Punch
AN-D-1-1/2	1-1/2" Round Die
AN-P-1-5/8	1-5/8" Round Punch
AN-D-1-5/8	1-5/8" Round Die
AN-P-1-3/4	1-3/4" Round Punch
AN-D-1-3/4	1-3/4" Round Die
AN-P-2	2" Round Punch
AN-D-2	2" Round Die
AN-B1	Base w/Pilot Pin, Fits 1/2" to 1-7/8"
AN-B2	Base w/Pilot Pin, Fits 2" to 2-1/2"
AN-PP-2491	Pilot Pin for AN-B1
AN-PP-3125	Pilot Pin for AN-B2
AN-HM-P	HM Punch
AN-HM-D	HM Die
AN-HM-B	HM Base w/Pilot Pin
AN-HM-PP	HM Replacement Pilot Pin
AN-HM-HB	HM Replacement Head Bolt Only
AN-S2-C-P	S2-C Punch
AN-S2-C-D	S2-C Die
AN-S2-C-B	S2-C Base w/Pilot Pins
AN-S2-C-L	S2-C Layout Tool
AN-PP-2491	S2-C Replacement Pilot Pin (2 Needed)
AN-211-P	211 Punch
AN-211-D	211 Die
AN-211-B	211 Base w/Pilot Pin
AN-211-PP	211 Replacement Pilot Pin, .310 Sq.
AN-209-PDB	209 Punch/Die/Base

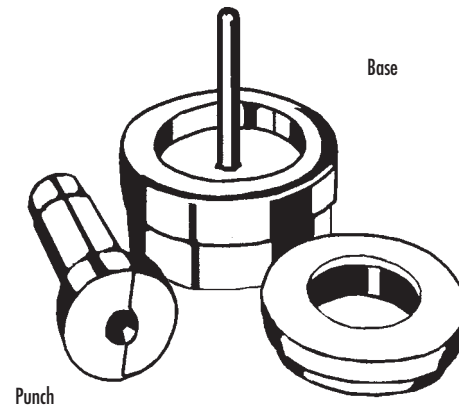

Round Pattern



HM Pattern



S2-C Pattern



211 Pattern



**LETTER FORMING BRAKE**

The Roper #99 bending brake has slotted jaws and apron which is designed for braking sheet metal strips on which bent up edges or seams have already been formed. It is small enough to be moved around the shop for convenience or trucked to an installation site.

Catalog Number	Description
ROP-99	Letter forming "Finger" Brake

**Specifications**

Capacity Mild Steel	20 ga.
Max. Bending Length	12"
Slot Depth	3/4"
Max. Jaw Opening	1-1/2"
Weight	185 lbs.

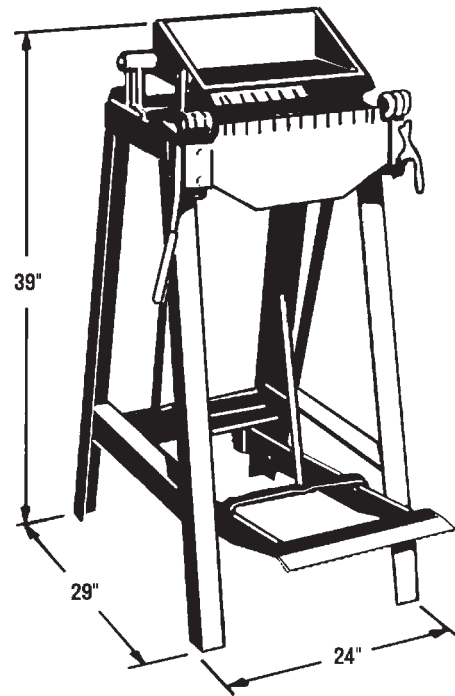

**Three types of drum return formed on no. 99 letter forming brake**

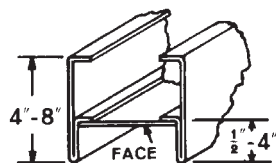

**CHANNEL BLOCK TYPE**  
(WITH RACEWAY FOR WIRING, TRANSFORMER, ETC.)

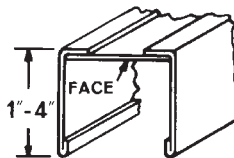

**CHANNEL TYPE**  
(NEON OR INCANDESCENT PROTECTED TYPE)

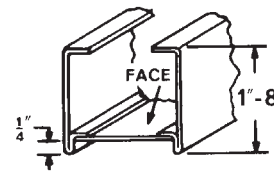

**BLOCK TYPE**  
(USED PLAIN OR ILLUMINATED)

DRUM RETURN VARIES IN THICKNESS FROM 24 GA. THRU 18 GA. FACE IS USUALLY 14 GA. AND IS EITHER ARC OR SPOT WELDED TO THE RETURN.



FACE OF LETTER CUT OUT FIRST

DRUM RETURN IS FORMED IN SUITABLE LENGTH ON LARGE BRAKE, NOTCHED, AND THEN FORMED ON No. 99 LETTER FORMING BRAKE.

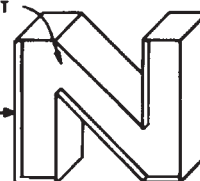

Hardware

## CHANNEL BABY LETTER FORMING BRAKE



A high quality economical bench mountable letter forming break. Wide jaw design opens to 4" to make channel letter fabrication simple. Bends aluminum thicknesses from .032 to .063 in widths up to 9" by unlimited length. Blade width: 9.5", side depth: 5/8". Other versions also available. Made in U.S.A.

Catalog Number	Weight (Lbs.)
CHA-BABY	17

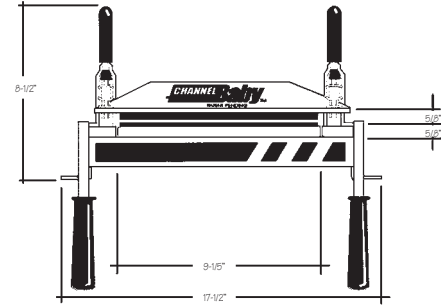
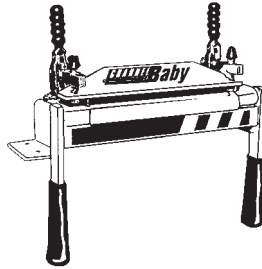

## WILDER WORKHORSE POWER SLITTERS

Wilder workhorse power slitters are high quality, economical slitters that are capable of slitting sheet metal, aluminum, stainless steel, plastics, copper, brass, galvanized and mild steel. A unique "hollow ground" and reversible double edged high carbon/high chromium blade is standard on all Wilder slitters which is designed to increase blade use as well as blade life.

At 215 pounds, Model 2024 is the lightest and most versatile slitter on the market today. Pound for pound, this slitter is built to take on all the work that lightweight sign shops and sheetmetal shops are willing to dish out. Powered by a 1/3 horsepower electric motor, requiring only 115 volts and drawing 6.6 full load amps, the self-feeding WIL-2024 offers unlimited productivity with low operating costs. With the standard slitting feed rate of 90 ft. per minute (6.7 seconds for a 10ft. sheet) and the approximate 4 seconds needed to move and lock-down the guidebar for width of cut, one can easily see how quick it is to increase efficiency with a Wilder Power Slitter.

WIL- 2024 slits to a maximum thickness of 20 gauge mild steel, with no limit of length. The minimum allowable slitting width is 1-1/4 inches with the maximum width being 24-1/4 inches.

Model 1624 is the most affordable and popular slitter used today. Powered by a 115 volt, 3/4 horsepower electric motor, the WIL-1624 is self-feeding and will slit materials of unlimited lengths at the feed rate of 90 ft. per minute. (18 inches per second). With a maximum thickness capacity of 16 gauge mild steel, a minimum slit width of 1-1/4 inches and a maximum slit width of 24-1/4 inches, the Model 1624 offers a variety of applications with increased productivity.

The quick and improved back gauge system allows for more rigidity and precise movements, resulting in more accuracy and consistency in every cut.

Catalog Number	Description
WIL-2024	20 Gauge Slitter
WIL-1624	16 Gauge Slitter
WIL-12276	5-1 Angle Iron Stand Assembly
WIL-22277	SM2 Premium Stand w/Shelf

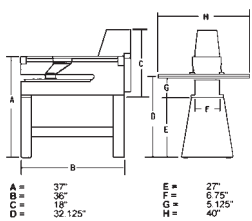

WIL-2024  
Shown mounted on  
WIL-12276 stand.

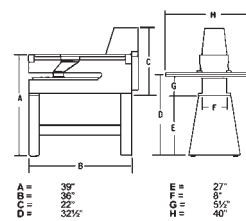
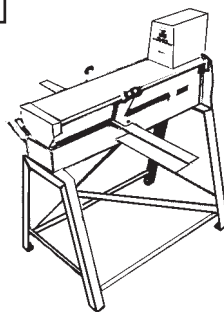

WIL-1624  
Shown mounted on  
WIL-22277 stand.

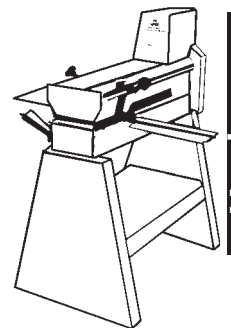

Hardware

**CAPACITY**

Mild Steel	20 Ga.	.0359"
Galvanized Sheet Metal	20 Ga.	.0396"
Stainless Steel	22 Ga.	.0300"
Aluminum		.0620"
Copper		.0620"
Brass		.0620"

\*Plastics.....078" Max  
\*Thickness: Polycarbonate, Plexiglas, Acrylonitrile, Cellulose Acetate, Acrylic, PVC, Hitecort (Styrene)

**SPECIFICATIONS**

Cutting Capacity (Mild Steel)	20 Ga
Maximum Slitting Width	24-1/4"
Minimum Slitting Width	1-1/4"
Feed Direction	Right to Left
Slitting Speed	90 Ft./Min.
Horsepower	1/3 Hp
Voltage	115 Volts
Phase	1 Ph
Cycle	60 Hz.
Full Load Amps	6.6 Amp.
Shaft Diameter	1-1/4"
Blades (Std.)	4" x 500" x 500" 2 Pcs.
Side Wall Thickness	Steel Plate.....3/32"
Dry Weight	215 lbs.
*Approx. Shipping Weight	280 lbs.

\*Weight may vary due to accessories.

**CAPACITY**

Mild Steel	16 Ga.	.0598"
Galvanized Sheet Metal	16 Ga.	.0635"
Stainless Steel	18 Ga.	.0480"
Aluminum		.0800"
Copper		.0800"
Brass		.0800"
Tuss Plates (Special Blades)	16 Ga.	.0635"

\*Plastics.....109" Max  
\*Thickness: Polycarbonate, Plexiglas, Acrylonitrile, Cellulose Acetate, Acrylic, PVC, Hitecort (Styrene)

**SPECIFICATIONS**

Cutting Capacity (Mild Steel)	16 Ga
Maximum Slitting Width	24-1/4"
Minimum Slitting Width	1-1/4"
Feed Direction	Right to Left
Slitting Speed	90 Ft./Min.
Horsepower	3/4 Hp
Voltage	115/208-230 Volts
Phase	1 Ph
Cycle	60 Hz.
Full Load Amps	10.6/5.3 Amps.
Shaft Diameter	1-1/2"
Blades (Std.)	4" x 500" x 750" 2 Pcs.
Side Wall Thickness	Steel Plate.....1"
Dry Weight	375 lbs.
*Approx. Shipping Weight	450 lbs.

\*Weight may vary due to accessories.

**ROPER METAL WORKING TOOLS**

The #4 shear with its standard blade cuts up to 2x2x1/4" angle iron with varying degrees of distortion. ROP-4-25 contour movable blade minimizes distortion but reduces the capacity to 2x2x3/16".

ROP-CTL-20 is a heavy duty portable punch with a 20 ton capacity. The frame around the die pocket is machined flat to allow punching close to the web of angle iron (9/16" from web to center of hole). Handle extension should be 3/4" pipe, 48 to 60" in length which is not supplied. An optional ROP-119 ratchet handle is available for working in close quarters. Maximum hole capacity is 9/16". 9/16" round tooling and other sizes from 1/8" to 17/32" are available upon request.

Replacement parts available upon request.

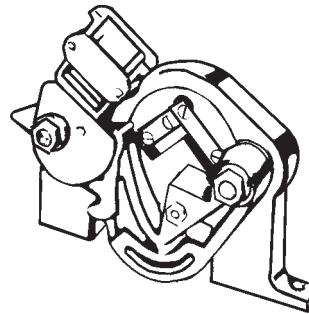

#4

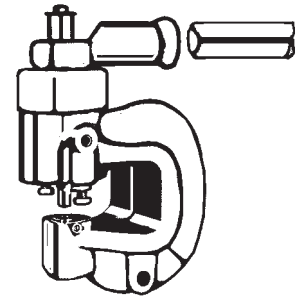

CTL-20

Catalog Number	Description
ROP-4 ROP-4-25	Angle Iron Shear w/ Standard Blade and 72" Handle Contour Movable Blade for ROP-4
ROP-CTL-20 ROP-119	Portable Punch Ratchet Handle for CTL-20

**ROPER FOOT SQUARING SHEAR**

ROP-152 shear offers triple-action shearing which includes relief on both edges of both the fixed and moving blades. It eliminates blade-to-blade friction, provides "bite" to eliminate sheet movement under shearing stress and produces double penetration in its cutting action. All contribute to easier operation. Will accommodate up to a 52" sheet.

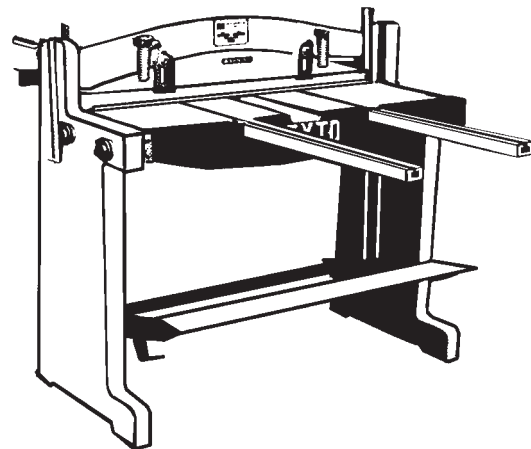

Catalog Number	Description
ROP-152	52" Foot Squaring Shear, 16 Ga. Capacity

**CONNECTICUT BRAKE**

Floor brakes are all steel construction, no castings. Features include heavy tie rods for minimum deflection, removable bending bar & angle, adjustable apron hinges and positive rear adjustment and clamping. Also features an apron stop rod for repeat bends, replaceable bushings, bronze hinge pin and long handles for extra leverage. Full capacity, 1" flange, bar and angle in place. Improved leg design for neat appearance and lighter weight. Other variations also available.

*Connecticut*

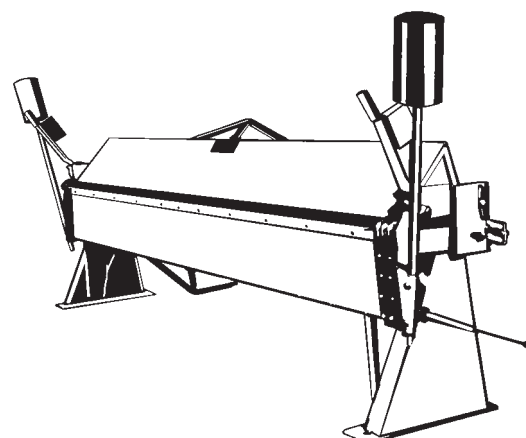

Catalog Number	Description
ROP-1016	121" Connecticut Brake, 16 Ga. Capacity
ROP-1018	121" Connecticut Brake, 18 Ga. Capacity

**PLIERS • CUTTERS • STRIPPERS**

Shown are the most commonly requested hand tools normally stocked. All supplied with vinyl grips. Many other high quality hand tools available upon request.

Catalog Number	Description	Mfg.
PRO-209G	Diagonal Cutters	Proto
PRO-226G	Longnose Pliers	Proto
CHA-337WG	Diagonal Cutter/Strippers for #12-14	Channelock
CHA-420G	Adjustable Pipe Pliers "Channelocks"	Channelock
KMI-101S	Wire Strippers w/Return Spring	K. Miller
THO-18-340	Automatic Wire Strippers	T & B
VAC-1963	Wiring Tool, Cuts/Strips/Crimps	Vaco

**PROTO CHANNEL LOCK Miller VACO T&B**

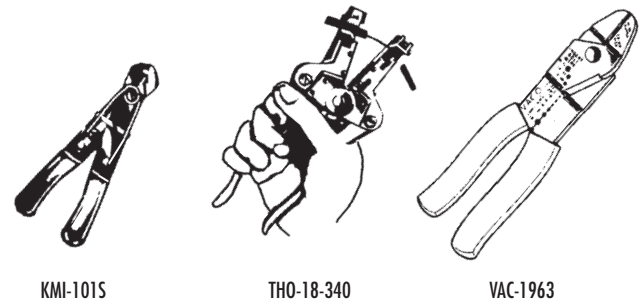
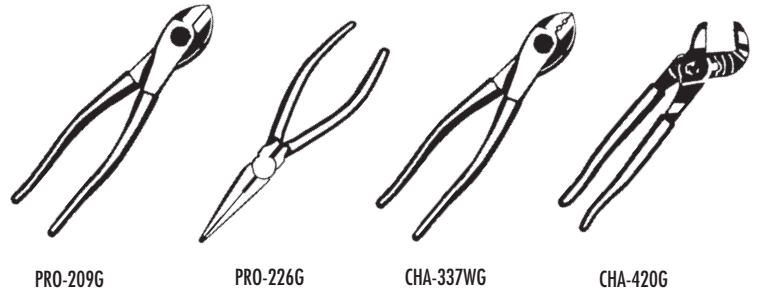

**GLASS FILES**

Quality file heat treated for long lasting cutting edges. Used for cutting glass tubing. Manufactured with a red tang.

Catalog Number	Description	Put Up
SIM-FILE-6	6" Warding Bastard File	12

**SIMONDS**

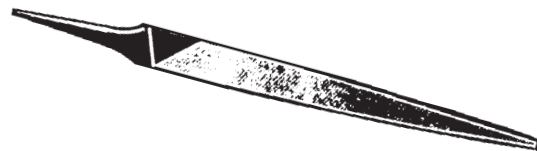

**HACKSAW BLADES**

Catalog Number	Description	Mfg.	Put Up
BLU-1224UL-1	Hacksaw Blade, 12", 24 Teeth Per Inch	Greenfield	10/100
BLU-1232UL	Hacksaw Blade, 12", 32 Teeth Per Inch	Greenfield	10/100



**GREENFIELD INDUSTRIES**

Hardware





**MAP MEASURES**

CAL-SM-C Scale Master Classic is a digital measure with 72 built-in scales including 39 Imperial scales (feet/inches) and 33 Metric scales. It also has 6 custom scales which can be used to "roll" or define any scale, 2 built-in memories, push button counter, many dimensional units and a subtract key. 1 year manufacturer's warranty.

DIE-1723 measures up to 100' in feet, inches and 1/8" increments.

Catalog Number	Description
CAL-SM-C	Digital Map Measure
DIE-1723	100' Map Measure
CAL-5007	Wheel replacement kit for CAL-SM-C.



DIE-1723



CAL-SM-C

**KNIVES & BLADES**

X-Acto products have many shop uses. INT-SERB single edged razor blades are the sharpest and most durable blades available. OLF-ROL-CUT "Rolling Scissors" allows straight cuts in various thicknesses of paper or vinyl film. Simply push scissors forward and the rolling blade begins to cut. It is durable and safe as no sharp blades are exposed. LUT-82 is a quality, easily adjustable utility knife available in safety orange. Supplied with 3 blades.

Catalog Number	Description	Mfg.	Put Up
XAC-3001	Knife Handle w/One Blade	X-Acto	1
INT-SERB	Razor Blades	X-Acto	100
OLF-ROL-CUT	Rolling Scissors	Olfa	1
LUT-82	Utility Knife, Retractable	Lutz	1
XAC-11	Pack of 5 #11 Blades	X-Acto	5
XAC-611	Pack of 100 #11 Blades	X-Acto	100
XAC-616	Pack of 100 #16 Blades	X-Acto	100
INT-2NSH	2 Notched Blade fits LUT-82, etc.	-	5/100



XAC-3001



XAC-616



LUT-82

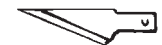

XAC-11

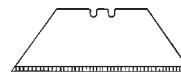

INT-2NSH



OLF-ROL-CUT

**RUOFF NOTCHER**

The Ruoff notcher is a punch press with an adjustable automatic feed designed to punch shapes along the edge of sheet material. Sheet steel up to 16 gauge, stainless up to 20 gauge, aluminum, plastics, cardboard or any sheet material that can be punched can be handled by the Ruoff notcher.

On automatic feed, this notcher can make up to 240 notches a minute. The depth of the notches can be set from 1/8 to 7/8" and the distance between notches can be adjusted from 5/16 to 1-1/8". Various die patterns available are shown below. Notcher is supplied with a #1 pattern die and is equipped with a 115/230 volt motor. RUO-93, a non-marring wheel set is also available and is useful when working with pre-finished metals and delicate materials. Replacement parts available upon request.

Catalog Number	Description
RUO-RAN1	Automatic Notcher w/#1 Die
RUO-1	#1 Punch and Die Set
RUO-2	#2 Punch and Die Set
RUO-3	#3 Punch and Die Set
RUO-4	#4 Punch and Die Set
RUO-5	#5 Punch and Die Set
RUO-93	Non-Marring Feed Wheel Set

**RUOFF**

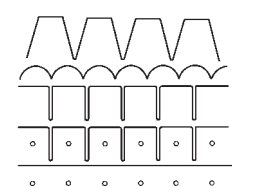
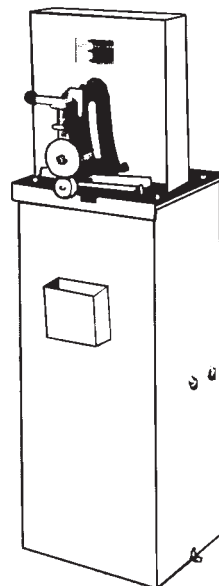

Die Pattern



Notched Flange for Curved Displays



Notched Flange for Metal Letters

**WISE GRIP TOOLS**

**WISE-GRIP**

Catalog Number	Description	Jaw Depth	Throat Depth	Throat Height
PET-6R	6" C-Clamp	2"	1-1/2"	2"
PET-8R	8" Sheet Metal Clamp	-	-	-
PET-9R	9" Welding Clamp	1-5/8"	-	-
PET-10R	10" Pliers	1-1/4"	-	-
PET-11R	11" C-Clamp	3-3/4"	2-5/8"	3-3/4"
PET-18R	18" C-Clamp	7"	10"	4"
PET-452	Replacement Spring for 5WR, 6R	-	-	-
PET-422	Replacement Spring for 7R, 8R, 9R, 11R	-	-	-
PET-408	Replacement Spring for 10R	-	-	-

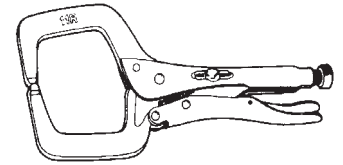

C-Clamp

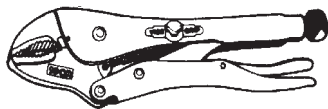

Pliers

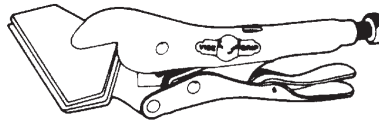

Sheet Metal Clamp

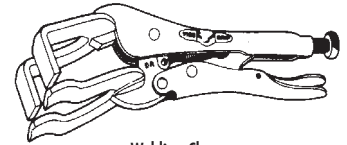

Welding Clamp



*The Most Complete Supplier in the West!*

Sign, Lighting & Electrical Supplies • Computer Sign Making Equipment • Display & Exhibit Supplies  
Creative Boards & Substrates • Digital Imaging & Laminating Supplies

Hardware

**PROFESSIONAL POWER TOOLS**

Many brand names are available. Any type of tool can be supplied. Most tools are available in several variations such as motor type, parts configurations, capability and battery size. Most tools are also available in kits and in cordless or pneumatic versions. Call for more information.

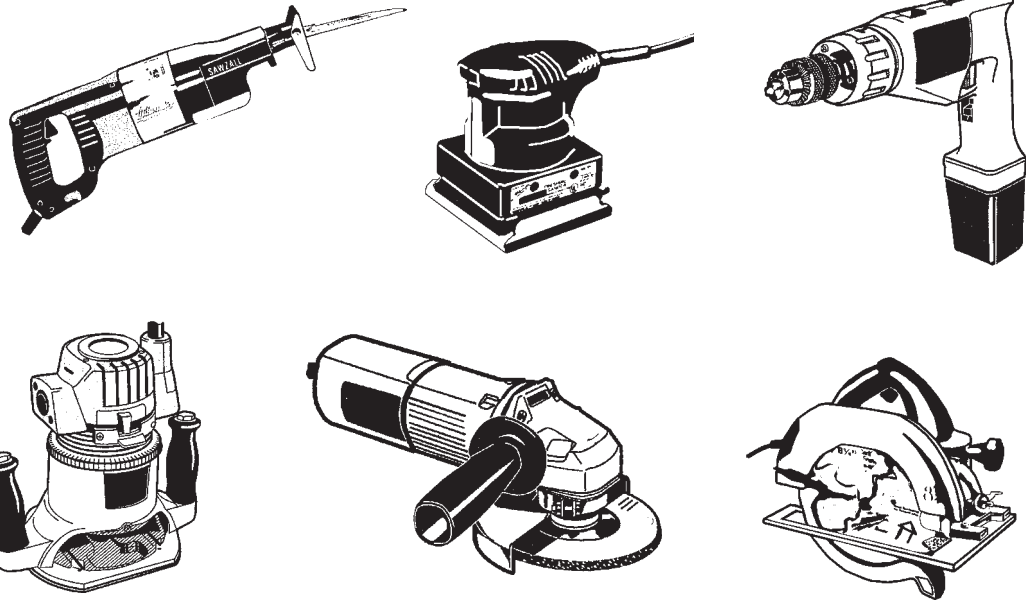

- Drills
- Hammer Drills
- Reciprocating Saws
- Circular Saws
- Routers
- Nibblers
- Power Sanders
- Grinders

**BOSCH PROFESSIONAL UNISHEAR**

The smallest, lightest, 16 gauge shear on the market. Visible blade allows precise pattern cutting, even when held upside down. Ideal for cutting plastic laminate.



Catalog Number	Description
BOS-1500C	16 Gauge "Unishear" Shear
BOS-BLADE-A	Replacement Blade Set for 1500 & 1500A
BOS-BLADE-B	Replacement Blade (1pc) for 1500B & 1500C

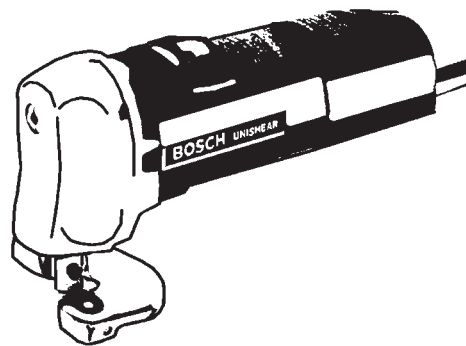

Hardware

**MISCELLANEOUS WELDING WIRE**

Most any type of welding wire can be supplied; i.e. alloy, size and configuration. Below is a commonly used and stocked wire.



Catalog Number	Description	Put Up
ER-4043-035	Aluminum Welding Wire, .035 Gauge	1 Lb. Roll

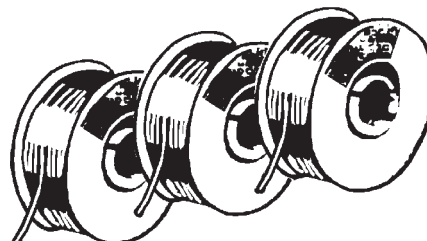



## MIG-135 WELDER

The MIG-135 welding system by OTC Daihen can accomplish a variety of welding processes including MIG welding of aluminum and stainless steel, MAG welding of mild steel and Arc Spot welding.

This system which consists of the WTG-43 welding torch and the CPSS-135 power supply is especially useful for welding aluminum extrusion kits and sheets.

WTG-43 is a light weight, well balanced torch. This ensures high stability and less operator fatigue. Since the wire spool is incorporated in the torch, welding is possible up to 35 feet from the power source, 60 feet with optional cable.

CPSS-135 power supply allows the selection of optimum welding parameters by merely setting the control knobs according to plate thickness and wire diameter used.

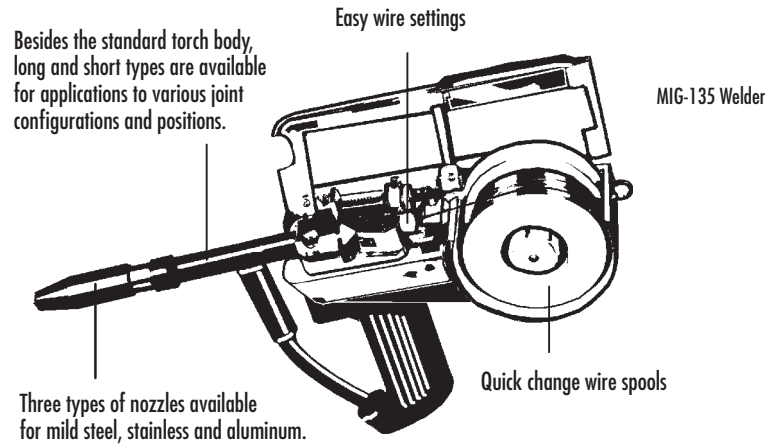

MIG-135 Welder

Catalog Number	Description
OTC-MIG-135	Welding Torch & Power Supply Kit Comes complete with 20' gas hose, primary input cable 25' control cable and 25' ground cable clamp.
OTC-WTG-43	Welding Torch Only Must be used in conjunction with a CPSS-135 Power Supply.

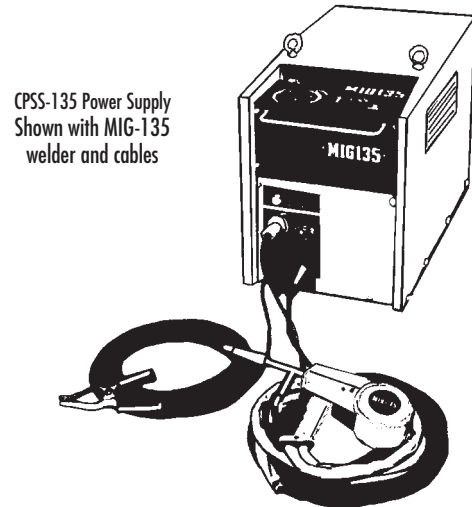

CPSS-135 Power Supply  
Shown with MIG-135  
welder and cables

## ARC SPOT TIMER

The E876A00 arc timer is virtually necessary for channel letter MIG spot welding.

Catalog Number	Description
OTC-E876A00	Arc Spot Timer

## WELDING WIRE

MB-4043 is best suited for aluminum and silicone alloys. This welding wire is made exclusively for the MIG-135 and is installed easily. Wires for other applications available upon request.

Catalog Number	Description	Weight Per Roll	Used For	Put Up
MB-4043-030	Aluminum Wire, .030 ga.	.44lb.	22 to 14 ga.	1/10/100

## WELDING ACCESSORIES

Accessories for other applications available upon request.

Catalog Number	Description
OTC-U2075J07	Long & Fine Tip, .030
OTC-U2075J06	Long & Fine Nozzle
OTC-U2464U04	Fine Tip, .030
OTC-U2464U01	Fine Nozzle
OTC-LTBS	Long Torch Body Set

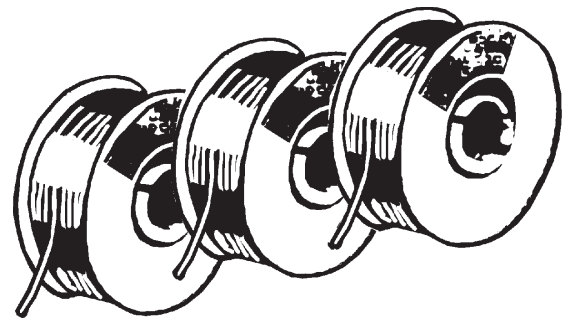

Hardware

**PETERSON PANEL SAWS**

Peterson manufactures a variety of moderately priced panel saws designed for job shops to production applications. Primary consideration in design are accurate cuts, speed in production, low maintenance and safety.

**Midblade Design**

The heart of the Peterson machine is the midblade carriage assembly (shown in the illustration below). With the blade centered between the guide rails there are no side pressures to deflect the blade from its straight line cut. The midblade unit can only lift in a vertical line if overloaded.

**Guide Rails**

All models use plated and polished 2" precision shafting guide carriage movement. The polished surface and durability of chromed rails enhances smoothness of operation and long life.

**Carriage Bushings**

Four sets of oil impregnated halves are used in combination with the chromed rails. A felt reservoir is inserted in the casting between bushing sets to assure proper lubrication between scheduled maintenance. Oil seals are located at ends of carriage to keep oil in and chips out. Bushing halves can easily be adjusted or even replaced without removing the carriage assembly.

**Saw Arbor Assembly**

Saw arbor assembly features one inch shaft with large four inch collars for blade stability (two and one-half inch collars can be supplied for special applications). Extra heavy duty, permanently lubricated and sealed bearings are used to assure best performance at high spindle speeds. Spindle speeds range from 2875 to 4200 rpm as needed. The arbor assembly utilizes adjustable bolts and lock nuts on both sides to maintain precise alignment. Cutting length is 100".

All saw motors are totally enclosed and fan cooled to keep sawdust out. Saw uses 10" blade with a cutting depth of 2" or 12" blade with a cutting depth of 3". Additional cutting lengths, motor configurations and accessories available upon request. Other saw models also available, call for more information. Please allow 3 to 4 weeks for delivery.

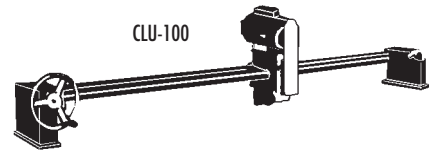

CLU-100

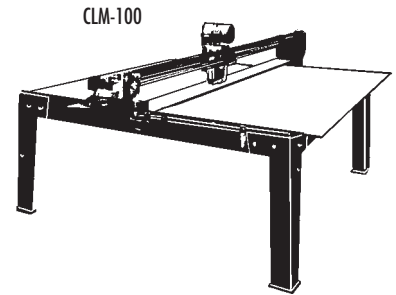

CLM-100

Midblade Design

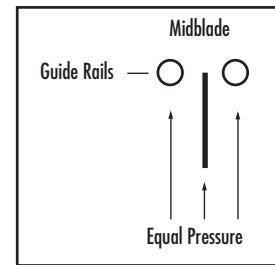

Catalog Number	Description	Cut Length	Motor Size	Approx. Weight (Lbs.)
CLU-100	Manual Feed, your mounting	100"	3HP, 230/460V	500
CLM-100	Manual Feed, on steel weldment	100"	3HP, 230/460V	800

## VERTICAL PANEL SAWS

Safety Speed Cut H-Series panel saws offer full-size vertical panel saw productivity in economical machines. Saws cut within 1/32" on a wide variety of panel materials up to 1-3/4" thick and are available in three cross-cut widths up to 76". These saws work in many applications including sign shops, lumber yards, crating shops and woodworking shops.

Catalog Number	Cross-Cut Max. Length	Cut Max. Thickness	Saw Blade Dia.	Power Requirements	Frame Length	Shipping Weight (Lbs.)
SSC-H-4	50"	1-3/4"	8"	120V, 13 Amp	10'	197
SSC-H-5	64"	1-3/4"	8"	120V, 13 Amp	10'	220
SSC-H-6	76"	1-3/4"	8"	120V, 13 Amp	10'	251

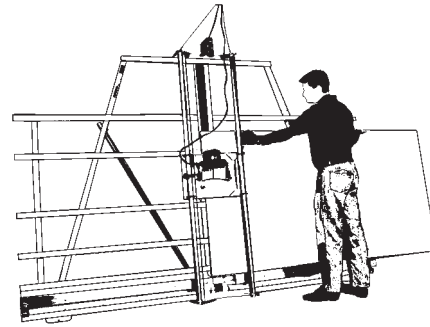

## PANEL SAW BLADES

A wide range of saw blades and router bits are available. Blades are carefully selected for cutting a variety of materials from plywood to foam board, from polycarbonate plastic to aluminum plate.

Catalog Number	Description	Saw Blade Type
SSC-848-ATBL	For Premium Wood, 8"	Carbide
SSC-860-TCG	For Plastics, Etc., 8"	Carbide
SSC-8200-HG	General Purpose, PC, 8"	HSS
SSC-860NRTCG	For Non-Ferrous Metals, 8"	Carbide

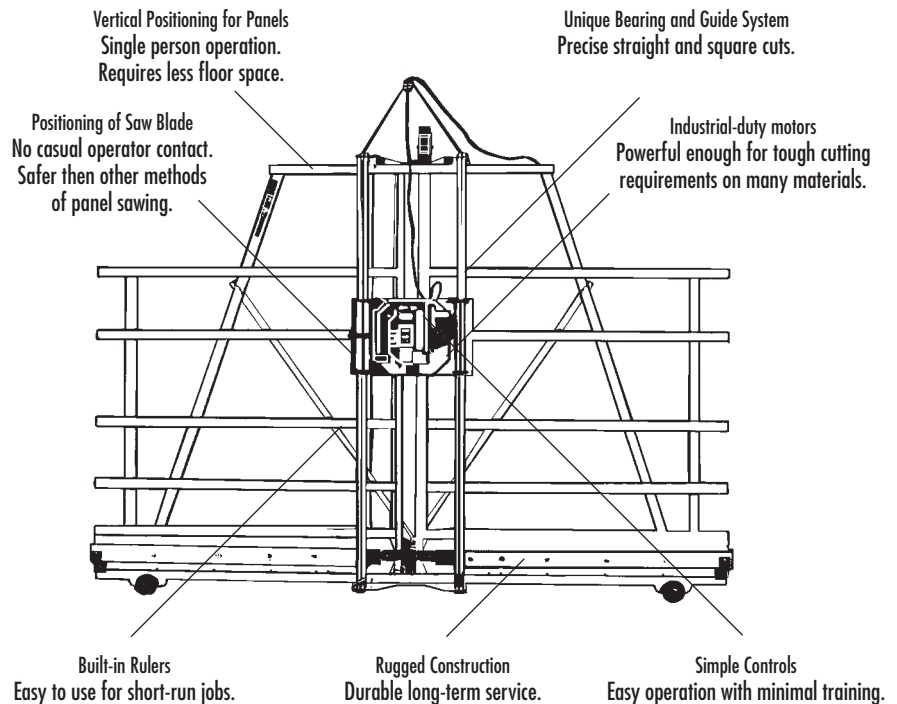

## PANEL SAW ACCESSORIES

Safety Speed Cut offers a full line of panel saw accessories. Shown are the most requested accessories. Some must be factory installed. Other accessories and a complete catalog available upon request.

### Mid-Way Fence

For working with small pieces, the mid-way fence brings the work up to waist-height and gives it firm support on a flat surface for the best alignment of the cut. The mid-way fence fits on both the left and right sides of the machine and includes rulers and a manual stop block.

Catalog Number	Description
SSC-H-6470	Mid-Way Fence

### Dust Collection Systems

Available for all SSC machines to meet the environmental needs of production shops. A kit containing the dust hood and hose can be connected into shop-wide dust systems or a stand-alone system. A vacuum can be installed with a 1HP or a 2-1/4HP motor fitted to either a 20 gallon tank or a 55 gallon adaptor.

Catalog Number	Description
SSC-H-456A	Dust Collection System, 1 HP.

### Hold Down Bar

A material hold down bar keeps thin and flexible materials tight against the frame for easier and safer cutting. Bars feature spring fingers with non-marring rollers to hold difficult materials.

Catalog Number	Description
SSC-H-440	H-4 Hold Down Bar
SSC-H-550	H-5 Hold Down Bar
SSC-H-660	H-6 Hold Down Bar

### Quick Stop

A quick stop adds an easy to use method of making repeat cuts all the same length to the saw. This accessory significantly increases the productivity of the saw or router.

Catalog Number	Description
SSC-H-6460	Quick Stop